



THE
MADGETTS
BLOCK



THE MADGETTS BLOCK





DJ's GROWERS SOIL TEST

Customer
The Madgetts Block

Crop
Grapes

Standard/Test Type
DJS Horticulture

Date
18 Apr 2019

Growth Stage
Established

Barcode
110083254

The Madgetts Block

► Shiraz Blocks - Weak Areas

Colour Olive Brown
Texture Medium clay

		Unit	Level Found	Ideal	Low	Ideal	High		
Properties	pH (water)		7.53	6-8					
	pH (CaCl2)		7.15	5.5-7					
	ECEC	meq/100g	23	5-25					
	Organic Carbon	%	1.94	1.5-3					
	PBI		85	40-80					
		Unit	Level Found	meq/100g	Deficient	Marginal	Ideal	High	Excessive
	Nitrate - N	mg/kg	6.2						
	Ammonium - N	mg/kg	2						
	Phosphorus (P-Colwell)	mg/kg	100						
	Potassium (K)	mg/kg	503	1.29					
	Sulphur (S)	mg/kg	100						
	Calcium (Ca)	mg/kg	3370	16.8					

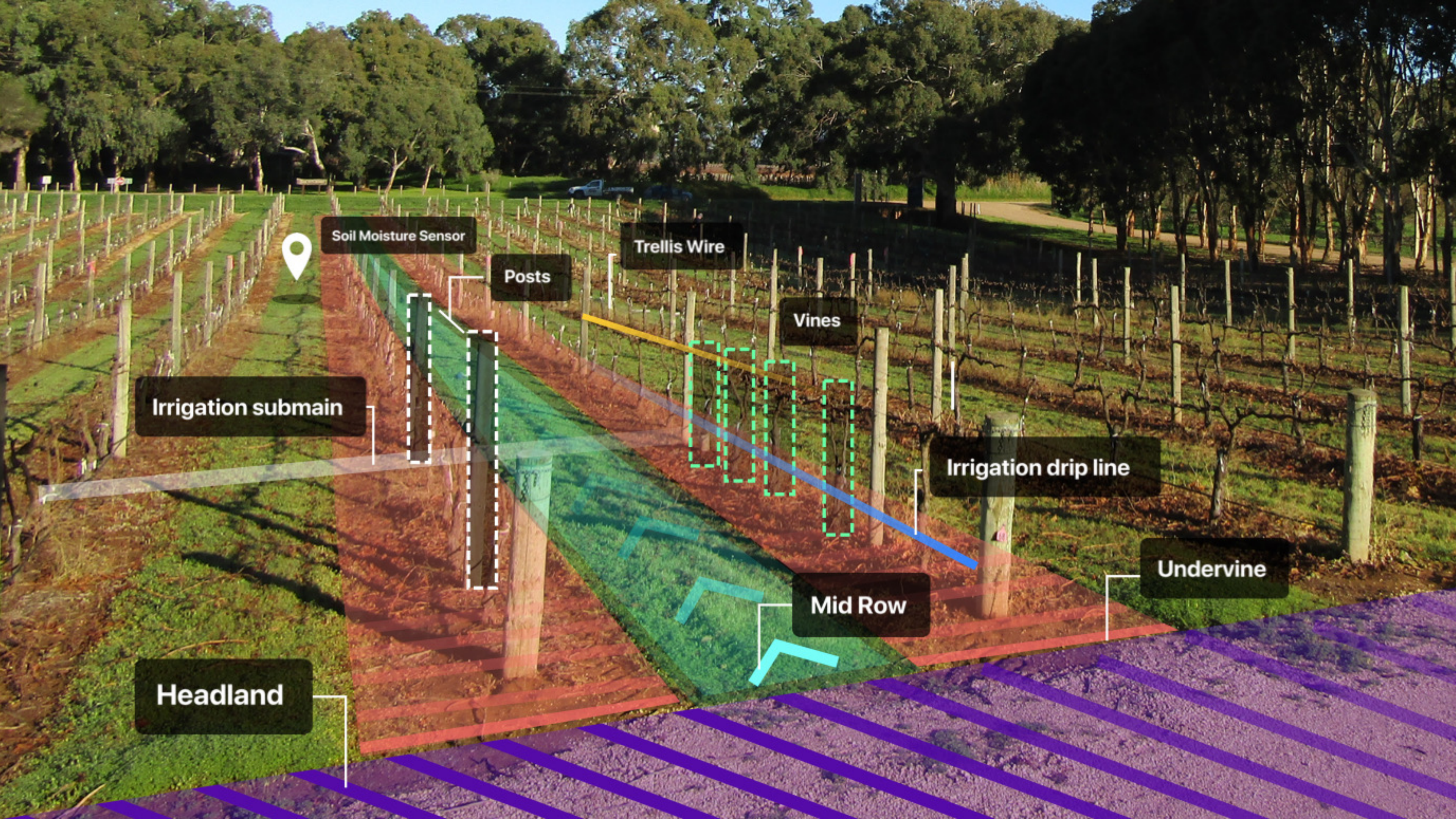

Soil Moisture Sensor

Trellis Wire

Posts

Vines

Irrigation submain

Irrigation drip line

Undervine

Mid Row

Headland



30m

Resume Work

Finish Work

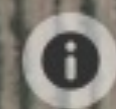











24

HERCULES

110628844

PLACE ON PAPERWORK

110628844

FISA

MADGETTS

NA

76

8

TMs-006B	TMs-046	TMs-039		
Dumas Total Organic Carbon	MIR - Aus Soil Texture	Core Bulk Density	Tonnes Soil Organic Carbon / ha (0-30cm)	
%		g/cm ³		
1.62	Silty clay loam	1.03	50.058	Mid Row
1.63	Silty loam	1.03	50.367	Under Vine
1.7	Silty loam	1	51	Mid Row
1.5	Silty loam	0.97	43.65	Under Vine
1.78	Silty loam	0.93	49.662	Mid Row
1.98	Silty loam	1.18	70.092	Mid Row
1.03	Silty clay loam	1.17	36.153	Mid Row
1.46	Silty loam	0.97	42.486	Under Vine
1.34	Silty loam	1.2	48.24	Under Vine
1.1	Silty clay loam	0.95	31.35	Mid Row
1.09	Silty clay	0.87	28.449	Mid Row
1.3	Silty loam	1.05	40.95	Under Vine
1.5	Silty clay loam	0.94	42.3	Under Vine
1.23	Silty clay loam	0.93	34.317	Mid Row
1.1	Silty clay loam	1.13	37.29	Mid Row
1.72	Silty clay loam	1.06	54.696	Under Vine
1.89	Silty clay loam	0.94	53.298	Mid Row
1.6	Silty clay loam	0.94	45.12	Under Vine
1.29	Silty clay loam	1.02	39.474	Mid Row
2.23	Silty loam	0.92	61.548	Under Vine
1.94	Silty loam	1.13	65.766	Under Vine
1.24	Silty clay loam	1.04	38.688	Mid Row
1.77	Silty loam	1.15	61.065	Under Vine
1.19	Silty loam	1.41	50.337	Mid Row
1.51			47	

Dumas Total Organic Carbon	MIR - Aus Soil Texture	Core Bulk Density	Tonnes Soil Organic Carbon / ha (0-30cm)	
%		g/cm ³		
1.62	Silty clay loam	1.03	50.058	Mid Row
1.63	Silty loam	1.03	50.367	Under Vine
1.7	Silty loam	1	51	Mid Row
1.5	Silty loam	0.97	43.65	Under Vine
1.78	Silty loam	0.93	49.662	Mid Row
1.98	Silty loam	1.18	70.092	Mid Row
1.03	Silty clay loam	1.17	36.153	Mid Row
1.46	Silty loam	0.97	42.486	Under Vine
1.34	Silty loam	1.2	48.24	Under Vine
1.1	Silty clay loam	0.95	31.35	Mid Row
1.09	Silty clay	0.87	28.449	Mid Row
1.3	Silty loam	1.05	40.95	Under Vine
1.5	Silty clay loam	0.94	42.3	Under Vine
1.23	Silty clay loam	0.93	34.317	Mid Row
1.1	Silty clay loam	1.13	37.29	Mid Row
1.72	Silty clay loam	1.06	54.696	Under Vine
1.89	Silty clay loam	0.94	53.298	Mid Row

Dumas Total Organic Carbon	MIR - Aus Soil Texture	Core Bulk Density	Tonnes Soil Organic Carbon / ha (0-30cm)	
%		g/cm ³		
1.62	Silty clay loam	1.03	50.058	Mid Row
1.63	Silty loam	1.03	50.367	Under Vine
1.7	Silty loam	1	51	Mid Row
1.5	Silty loam	0.97	43.65	Under Vine
1.78	Silty loam	0.93	49.662	Mid Row
1.98	Silty loam	1.18	70.092	Mid Row
1.03	Silty clay loam	1.17	36.153	Mid Row
1.46	Silty loam	0.97	42.486	Under Vine
1.34	Silty loam	1.2	48.24	Under Vine
1.1	Silty clay loam	0.95	31.35	Mid Row
1.09	Silty clay	0.87	28.449	Mid Row
1.3	Silty loam	1.05	40.95	Under Vine
1.5	Silty clay loam	0.94	42.3	Under Vine
1.23	Silty clay loam	0.93	34.317	Mid Row
1.1	Silty clay loam	1.13	37.29	Mid Row
1.72	Silty clay loam	1.06	54.696	Under Vine
1.89	Silty clay loam	0.94	53.298	Mid Row
1.6	Silty clay loam	0.94	45.12	Under Vine
1.29	Silty clay loam	1.02	39.474	Mid Row
2.23	Siltv loam	0.92	61.548	Under Vine











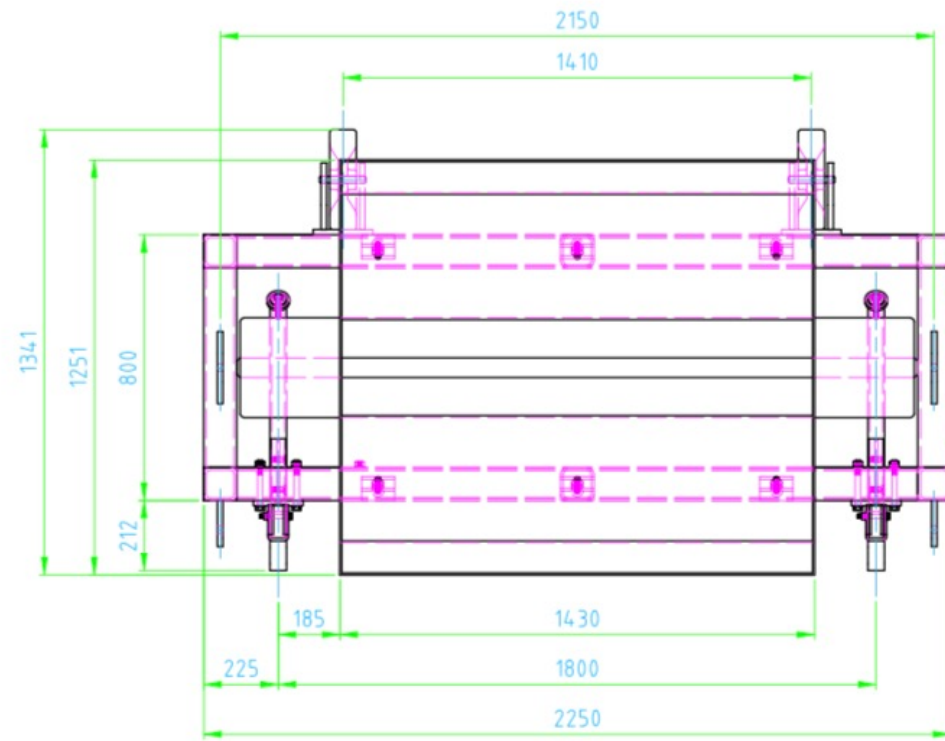

PLAN VIEW

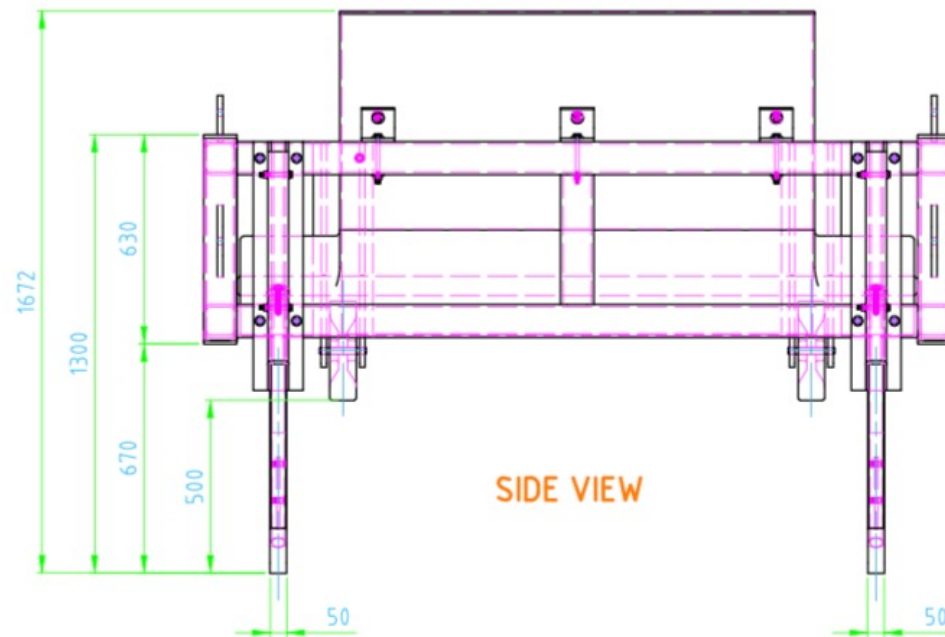

SIDE VIEW

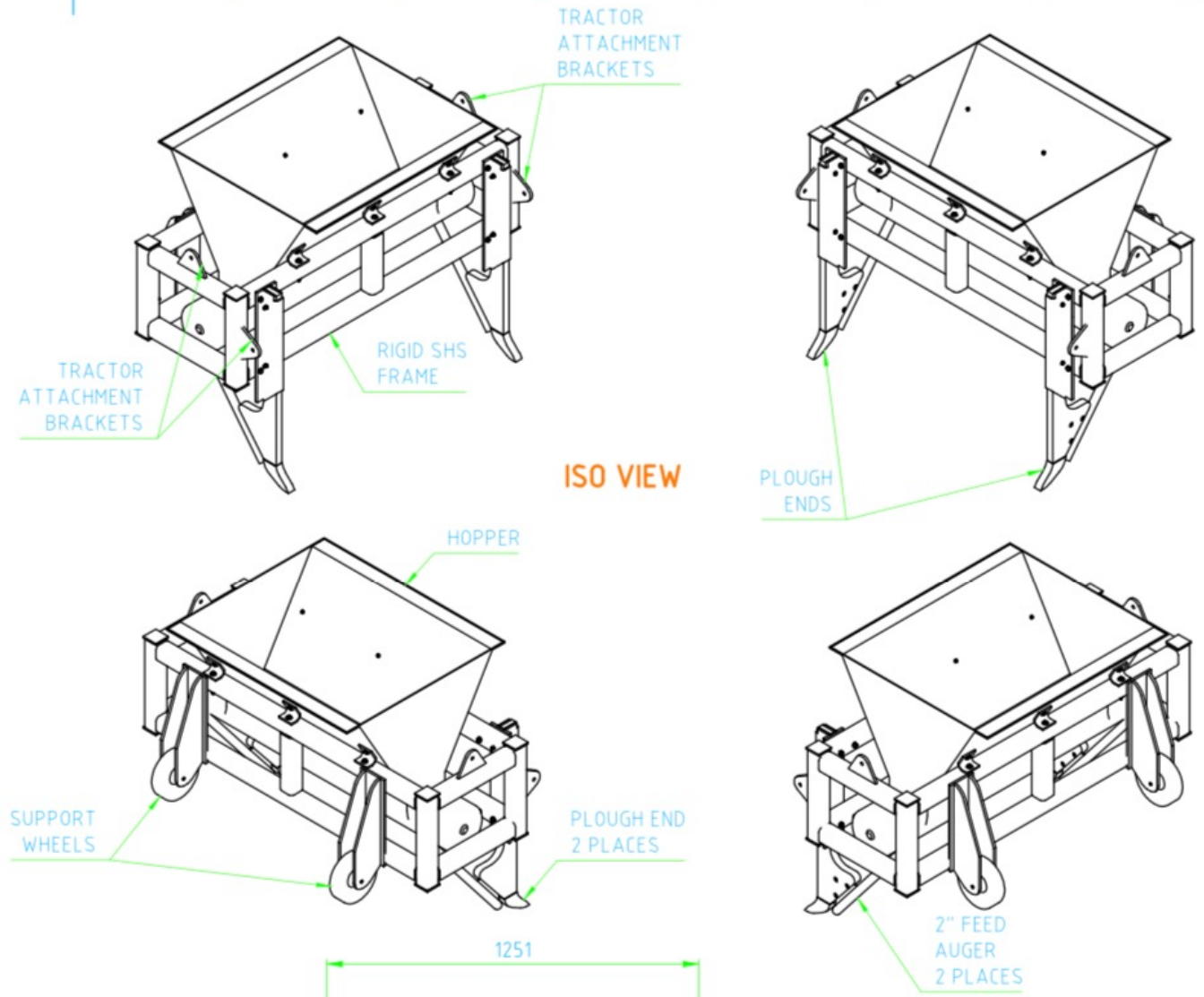

ISO VIEW

END VIEW

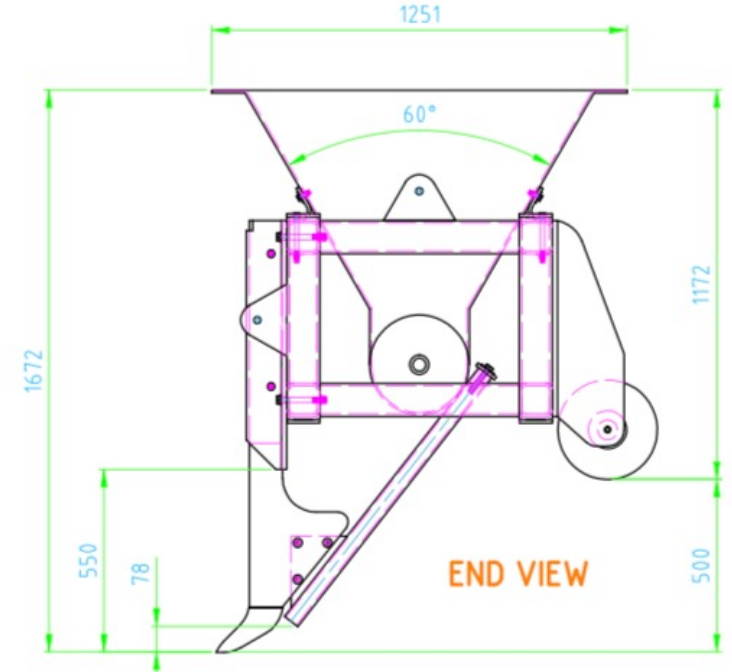

NO.	DATE	BY	REVISION

ALL DIMENSIONS IN MM UNLESS OTHERWISE STATED		DATE	27-08-2010	TITLE	JEFFRIES - VINEYARD COMPOST FEED HOPPER		
<p>This document must not be copied without our written permission, and the contents thereof must not be imparted to a third party nor be used for any unauthorised purpose.</p>		SCALE	1:1	JOB No.	DRG No.	SHT SIZE	
		MATERIAL	-				-----
DRAWN BY		N.BROADHURST					





94844-F

SOILKEE

RENOVATOR

www.soilkee.com.au

SOILKEE

RENOVATOR

www.soilkee.com.au

SOILKEE

RENOVATOR

SOILKEE

RENOVATOR





HARDY'S



SAUVIGNON BLANC
2019



Thanks

Oli Madgett - Co-founder CEO

oli@platfarm.com

0459 546 478